

THIS DRAWING IS UNPUBLISHED. RELEASED FOR PUBLICATION 20  
 © COPYRIGHT 20 BY - ALL RIGHTS RESERVED.

| REVISIONS |     |                           |           |       |
|-----------|-----|---------------------------|-----------|-------|
| P         | LTR | DESCRIPTION               | DATE      | APVD  |
| A1        |     | REVISED PER ECO-12-010330 | 04JUN2012 | DD RB |
| B         |     | REVISED PER ECO-15-004568 | 23MAR2015 | JM RB |
|           |     |                           |           |       |

- INSTRUCTION SHEET FOR ASSEMBLY AND DISASSEMBLY OF AMPSEAL 16 CONNECTORS: 408-8623.

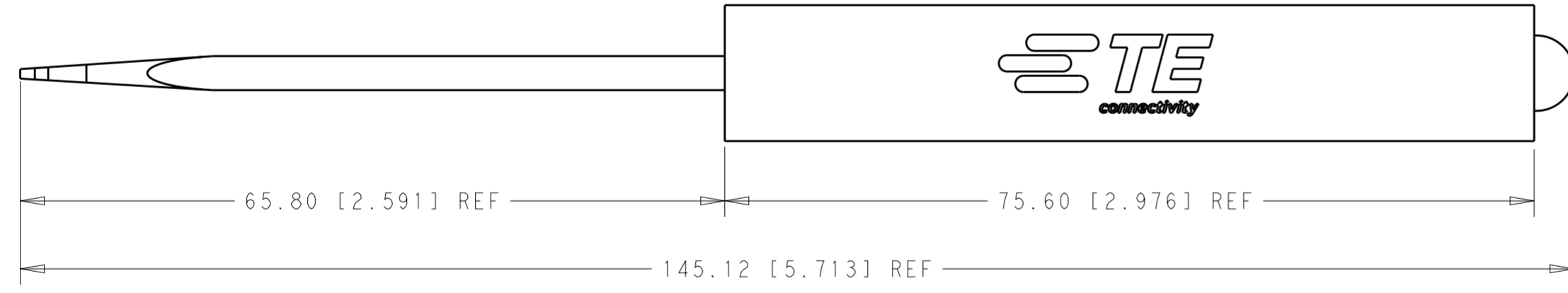
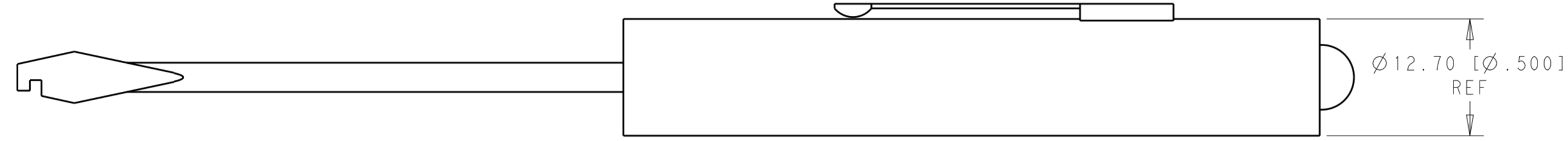

776441-1 SHOWN

776441-1  
TE PART NUMBER

|  |          |                  |           |   |               |
|--|----------|------------------|-----------|---|---------------|
| THIS DRAWING IS A CONTROLLED DOCUMENT. |          | DWN<br>R. COLE   | 15JAN2002 |   |               |
| DIMENSIONS:<br>mm [INCHES]             |          | CHK<br>M. TRULL  | 15JAN2002 |   |               |
| TOLERANCES UNLESS OTHERWISE SPECIFIED: |          | APVD<br>M. TRULL | 15JAN2002 | NAME<br>EXTRACTION TOOL,<br>TPA AND CONTACT, AMPSEAL 16 |               |
| 0 PLC ±                                | 1 PLC ±  | PRODUCT SPEC     | 108-2184  | SIZE  | CAGE CODE     |
| 2 PLC ±                                | 3 PLC ±  | APPLICATION SPEC | 114-13065 | DRAWING NO  | RESTRICTED TO |
| 4 PLC ±                                | ANGLES ± | WEIGHT           | 15.6g     | A200779   | C-776441      |
| FINISH -                               | -        | CUSTOMER DRAWING | SCALE 2:1 | SHEET 1 OF 1  | REV B         |